

**CAMBRIDGESHIRE & PETERBOROUGH MINERALS & WASTE PLAN:
CONSULTATION ON ISSUES & OPTIONS
ADDITIONAL SITES
(Report by Planning Policy Manager)**

1. INTRODUCTION

- 1.1 This report informs Cabinet of proposals for minerals and waste planning published by Cambridgeshire County Council and Peterborough City Council, and recommends a response on behalf of the District Council.

2. BACKGROUND

- 2.1 Cambridgeshire County Council and Peterborough City Council are responsible for minerals and waste planning in the county. In June / July 2005 they consulted on options for a new planning framework covering these matters, looking ahead to 2021. The Council submitted comments on these options which were approved by Cabinet on the 21st July 2005.
- 2.2 Following this consultation a number of additional locations have been proposed and the Minerals and Waste Planning Authorities are now seeking views on these locations. The closing date for comments was 13 March, but the County Council's officers have agreed that the District Council's views can be submitted following this meeting.
- 2.3 As a result of the planning reforms introduced in 2004 this new framework will comprise a number of elements (although Cambridgeshire and Peterborough intend to produce these in parallel):
- A Core Strategy setting out the overall vision, objectives and policies
 - A set of site-specific proposals
 - An 'Action Plan' for the Mepal/Earith area, which will examine this area in more detail in view of the numerous sites located there and the many associated issues such as highway impacts, flood protection and restoration
 - A Proposals Map
- 2.4 The proposed timetable for producing these documents is as follows:
- Initial consultation on issues & options (present stage) – June/July 05
 - Consultation on preferred options – March/April 06
 - Submission to Secretary of State – Jan/Feb 07
 - Examination – June 07
 - Adoption – December 07

3. THE ISSUES AND OPTIONS DOCUMENT

- 3.1 Members will recall that the Issues & Options document contained several sections:
- A series of questions about general policy issues that the Core Strategy may address.
 - A number of potential mineral extraction sites: some of these are new, some are extensions to existing sites and some are existing (but unimplemented) allocations that could be renewed.
 - Proposals for 'Mineral Safeguarding Areas' and 'Mineral Consultation Areas': the former are areas where known mineral resources would be safeguarded pending possible extraction in the longer term; the Consultation Areas cover areas where the potential is less well established, but where the Minerals Planning Authority would have to be consulted on any significant proposals that could compromise extraction.
 - A number of potential sites for waste management facilities (a mixture of new sites and existing allocations).
- 3.2 All of the site-specific proposals were presented first for Cambridgeshire as a whole (excluding Mepal/Earith) and then for the area that might form the Mepal/Earith Action Plan.

4. IMPLICATIONS AND POTENTIAL RESPONSES

- 4.1 Growth in Cambridgeshire will inevitably place continuing demands upon both the minerals industry and waste management facilities. Where possible it is desirable that sites are found within the county to address these requirements, thereby minimising the need for long-distance movement of materials. However it is essential that extraction, recycling and disposal operations take place in a way which safeguards the environmental quality of the area and the living conditions of local residents.
- 4.3 The suggested responses of the Council for the additional locations are contained in appendix 1.
- 4.4 Two general concerns should be raised again, the first of which is the process of site selection. It is understood that the potential new sites for mineral extraction and waste management facilities in the document are solely ones that have been proposed by the minerals and waste industry, following approaches by Cambridgeshire and Peterborough City Councils (it should be noted that they are not necessarily endorsed by the councils, and it is very unlikely that all of them will be required or allocated in the new plan).
- 4.5 This approach could fail to capture sites that such developers and operators do not have an interest in at present. This is a serious flaw, as it imposes an artificial limit on the range of options for consideration by stakeholders at this early stage of plan production. A particular need in Huntingdonshire is the requirement for a new waste recycling site to serve St Neots, although there are two sites proposed for this in the set of additional sites neither of them are suitable. The site identified on the A428 is unsuitable but a site within the vicinity of this road would be

beneficial and the District Council would welcome the opportunity to meet with the Waste and Minerals Authorities to discuss potential sites. The authorities should be urged to look more widely at potential opportunities for locating new facilities, and should also be asked to circulate any additional proposals that come forward as a result of the present consultation to key stakeholders (including the District Council), so that their relative merits can be considered.

- 4.6 The second concern is the very limited information about the potential sites that has been made available at this stage (no more than a series of maps). If stakeholder consultation is to be effective it must be supported by adequate information about the proposals, but the document fails to provide even a cursory analysis of site-specific constraints and potential impacts. The suggested responses in the appendix 1 are based upon officers' own analysis of the sites. The document also needs to provide an indication of how much of the aggregate supply target will be provided by recycling and how much through extraction so that a clear idea is given on the scale of provision required.

5. RECOMMENDATION

Cabinet is recommended to submit observations to Cambridgeshire County Council and Peterborough City Council along the lines set out in section 4 and Appendix 1 of this report.

BACKGROUND INFORMATION

Cambridgeshire County Council & Peterborough City Council (June 2005)
Cambridgeshire & Peterborough Minerals & Waste Development Plan: Issues and Options Paper

CONTACT OFFICER - enquiries about this report to Richard Probyn (Planning Policy Manager) 388430

APPENDIX 1: SUGGESTED RESPONSES TO POTENTIAL NEW WASTE MANAGEMENT SITES

Maps showing the sites concerned are included at the end of the appendix.

Site 3: Colne Fen Quarry, Earith

This site is East of Somersham at the existing Colne Fen Quarry. The potential use is waste recycling producing secondary aggregate and inert landfill.

Suggested response:

In principle there is no objection to this use at the site provided it is limited to the life of the current sand and gravel extraction. The impacts of the proposal on the local road network and country wildlife sites in the vicinity require careful assessment and appropriate mitigation measures. There is also a Site of Special Scientific Interest to the South East of the site.

Site 22: Woolpack Farm, Hemingford Grey

This site is located south of the A14, north west of Woolpack Farm, Hemingford Grey. The potential use is inert landfill and permanent waste recycling.

Suggested response:

Unacceptable. The site is located between a wooded area and a lake. The use of this site for inert landfill and permanent waste recycling would have an unacceptable visual impact. The site has a limited frontage onto the A14 and it is unclear how a suitable junction would be achieved. The impacts of the proposal on the road network in the vicinity will require careful assessment and appropriate mitigation measures. This is a Site of Special Scientific Interest to the West.

Site 23: St Neots

This site is located east of St Neots at the junction between the B1428 and the A428. The potential use is a household waste recycling centre.

Suggested response:

Unacceptable. This location is a gateway into St Neots and the impact the proposal would have on this and on the road network in the vicinity will require careful assessment and appropriate mitigation measures. Although this site is not suitable there is a need for a waste recycling site to serve St Neots and a site in the vicinity of the A428 would be beneficial.

Site 24: St Neots Sewage Works

This site is located north of St Neots south of the existing sewage works. The potential use is a household waste recycling centre.

Suggested response:

Unacceptable. This proposal would have an obtrusive impact on the landscape in an area which has been identified in the Council's emerging Core Strategy as an Area of Strategic Greenspace Enhancement. The impacts of the proposal on the road network in the vicinity will require careful assessment and appropriate

mitigation measures. There are Sites of Special Scientific Interest to the North and South West of the Site.

Site 28: Weybridge farm, Alconbury

This site is located north of the A14 between Ellington and Brampton. The proposal is for sand and gravel extraction.

Suggested Response:

Support in principle. A large area of the site has been used for sand and gravel extractions. This site would be an appropriate location for further sand and gravel extraction, particularly given the location of the proposed realignment of the A14. The impacts of the proposal on the road network in the vicinity will require careful assessment and appropriate mitigation measures.

Site 30: Needingworth Quarry, Needingworth

This site is north east of Needingworth. The potential use is waste recycling producing secondary aggregate.

Suggested Response:

In principle there is no objection to this use at the site provided it is limited to the life of the current sand and gravel extraction. The impacts of the proposal on the local road network and country wildlife sites in the vicinity require careful assessment and appropriate mitigation measures.

Site 31: Puddock Hill, Warboys

This site is located north of Warboys between Warboys Wood and Pingle Wood. The potential use is for Hazardous landfill and continuing waste recycling of non hazardous waste.

Suggested Response:

Unacceptable. Permission for the use of this site for the disposal of hazardous waste was refused in May 2004 and the subsequent appeal of this decision was withdrawn. The reason for refusal given included; sufficiently serious risks to human health and the water environment, stress on the social and economic fabric of the local community and the impact of odours. These reasons still apply. In addition to this the road infrastructure in this location is poor and the impact of the proposal on the local road network would require careful assessment and appropriate mitigation measures. A large are of the site is designated as a Site of Special Scientific Interest.

Site 35: ADAS site at Woodhurst, Huntingdon

This site is located east of Woodhurst. The proposal is for composting and waste recycling and recovery.

Suggested Response:

Potentially acceptable. This site has planning permission for the production of compost for agriculture, horticulture and landscaping and for the establishment of an ADAS composting research project. There would be a landscape impact along the east of the site which would require new landscaping. There is also an

orchard at the north of the site, the impact of the proposal on this and the local road network will require careful assessment and appropriate mitigation measures.



<p>SS4 Site 22: Option 1</p>	<p>Do you support this proposal for a waste management site, if so why?</p>
<p>SS4 Site 22: Option 2</p>	<p>Do you object to this proposal for a waste management site, if so why?</p>
<p>SS4 Site 22: Option 3</p>	<p>Do you support this proposal in part, subject to amendments? If so please indicate the amendments requested?</p>



**Cambridgeshire
County Council**
Environment &
Community Services

Topic SS4: New Waste Management Sites
**Site 23: St Neots (Household Waste
Recycling Centre) see also SS4 site 24**

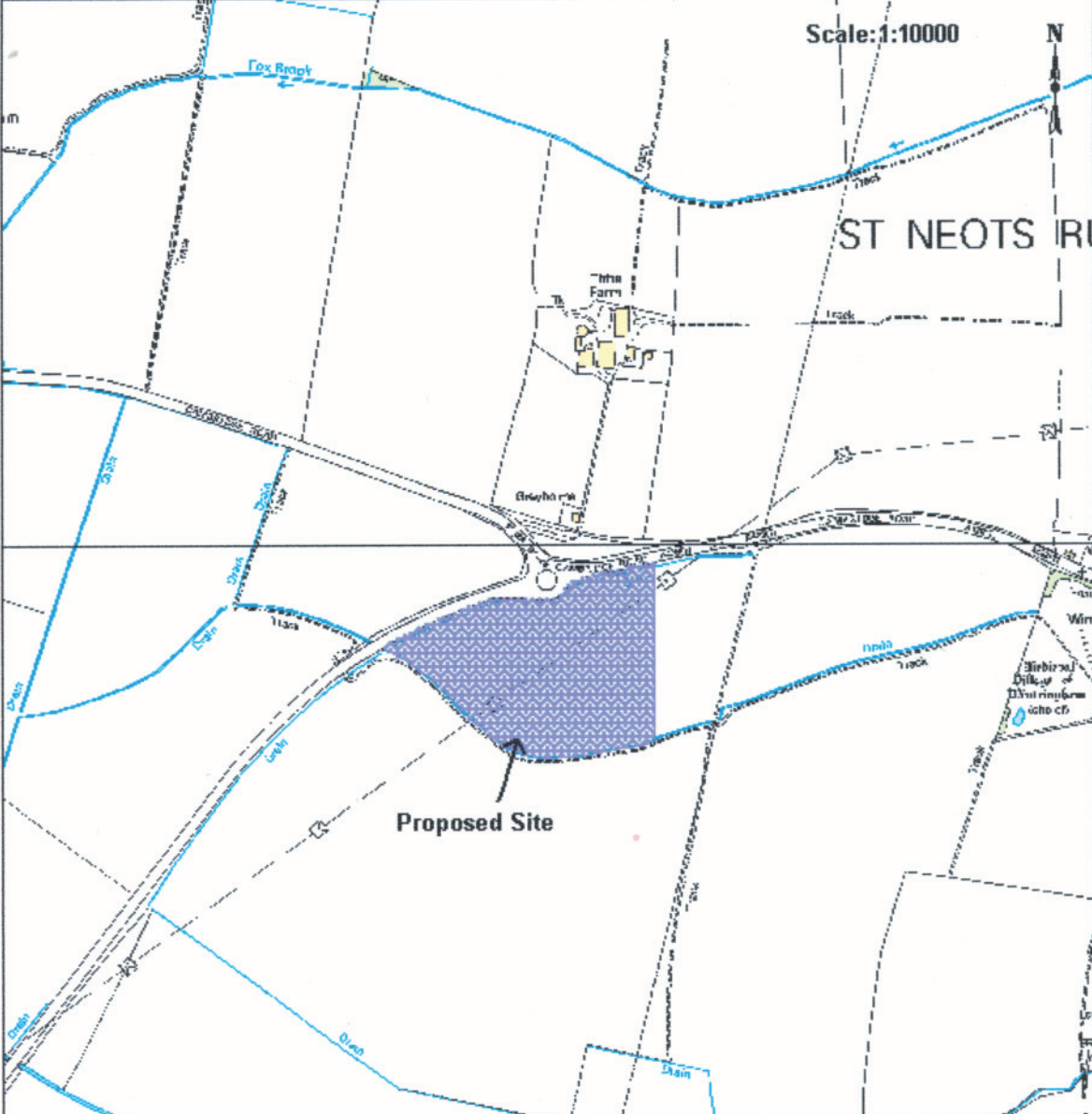

<p>SS4 Site 23: Option 1</p>	<p>Do you support this proposal for a new waste management site, if so why?</p>
<p>SS4 Site 23: Option 2</p>	<p>Do you object to this proposal for a new waste management site, if so why?</p>
<p>SS4 Site 23: Option 3</p>	<p>Do you support this proposal in part, subject to amendments? If so please indicate the amendments requested?</p>

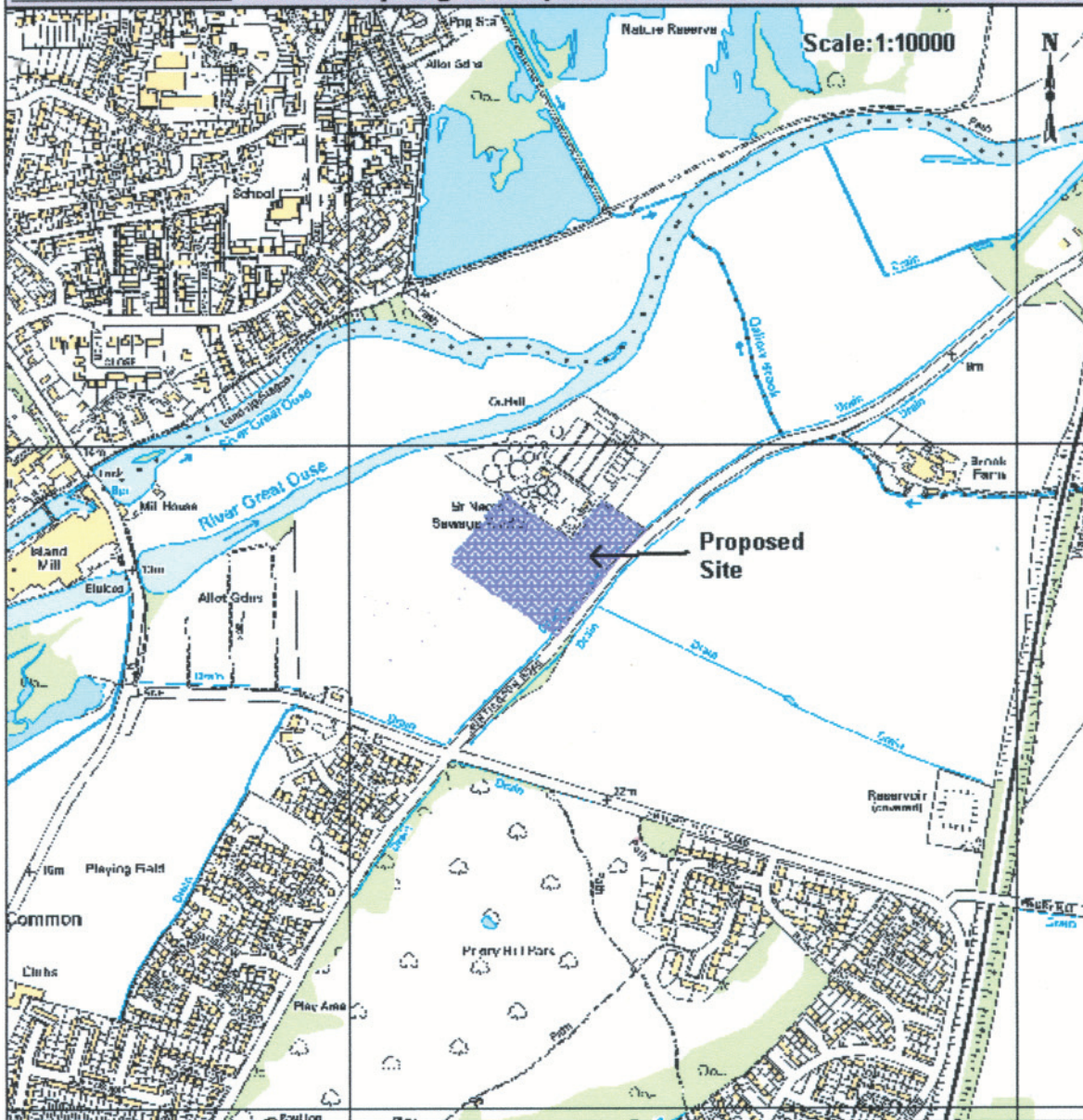

<p>SS4 Site 24: Option 1</p>	<p>Do you support this proposal for a new waste management site, if so why?</p>
<p>SS4 Site 24: Option 2</p>	<p>Do you object to this proposal for a new waste management site, if so why?</p>
<p>SS4 Site 24: Option 3</p>	<p>Do you support this proposal in part, subject to amendments? If so please indicate the amendments requested?</p>

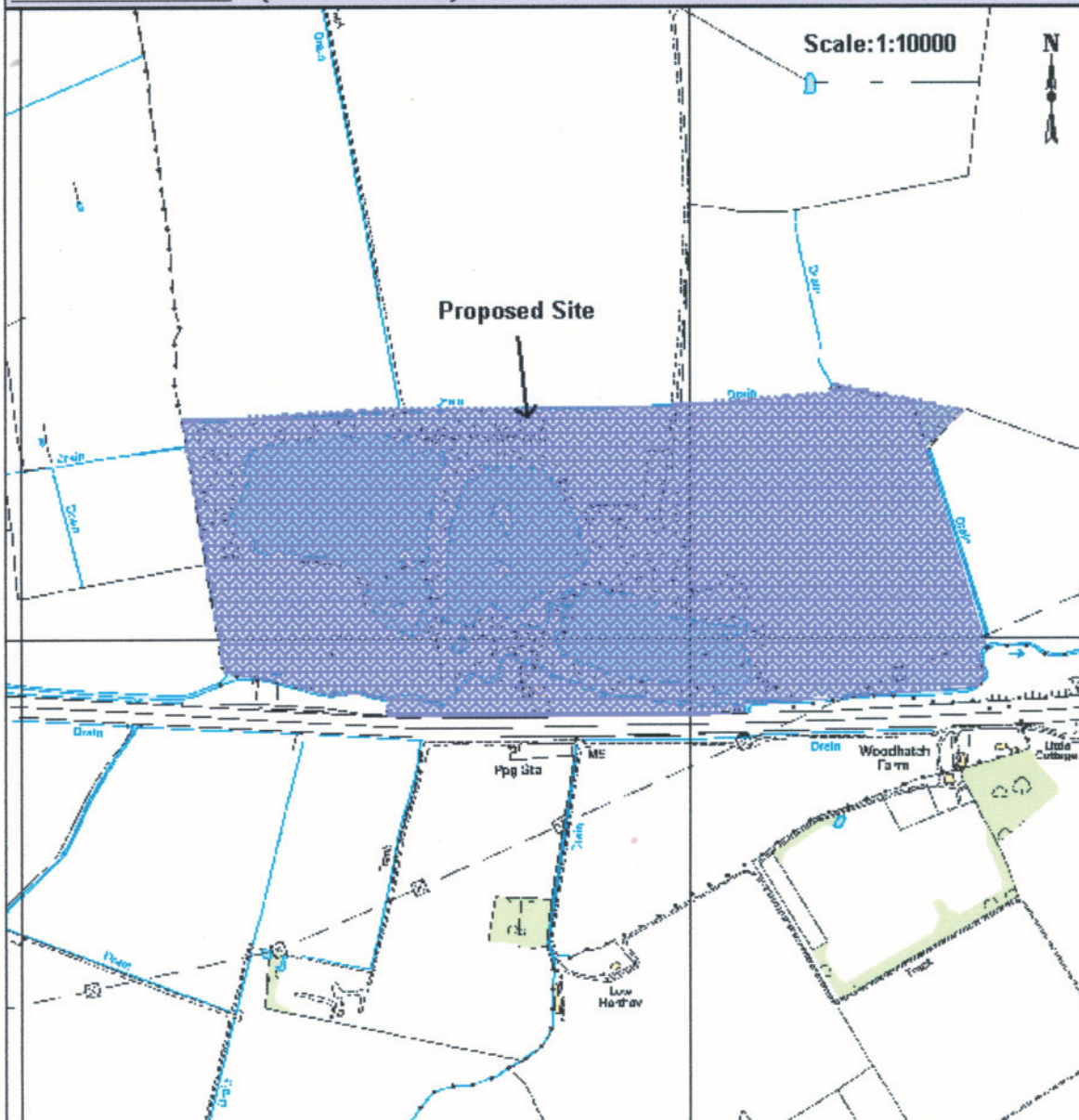

SS1 Site 28: Option 1	Do you support this proposal for a new minerals site, if so why?
SS1 Site 28: Option 2	Do you object to this proposal for a new minerals site, if so why?
SS1 Site 28: Option 3	Do you support this proposal in part, subject to amendments? If so please indicate the amendments requested?

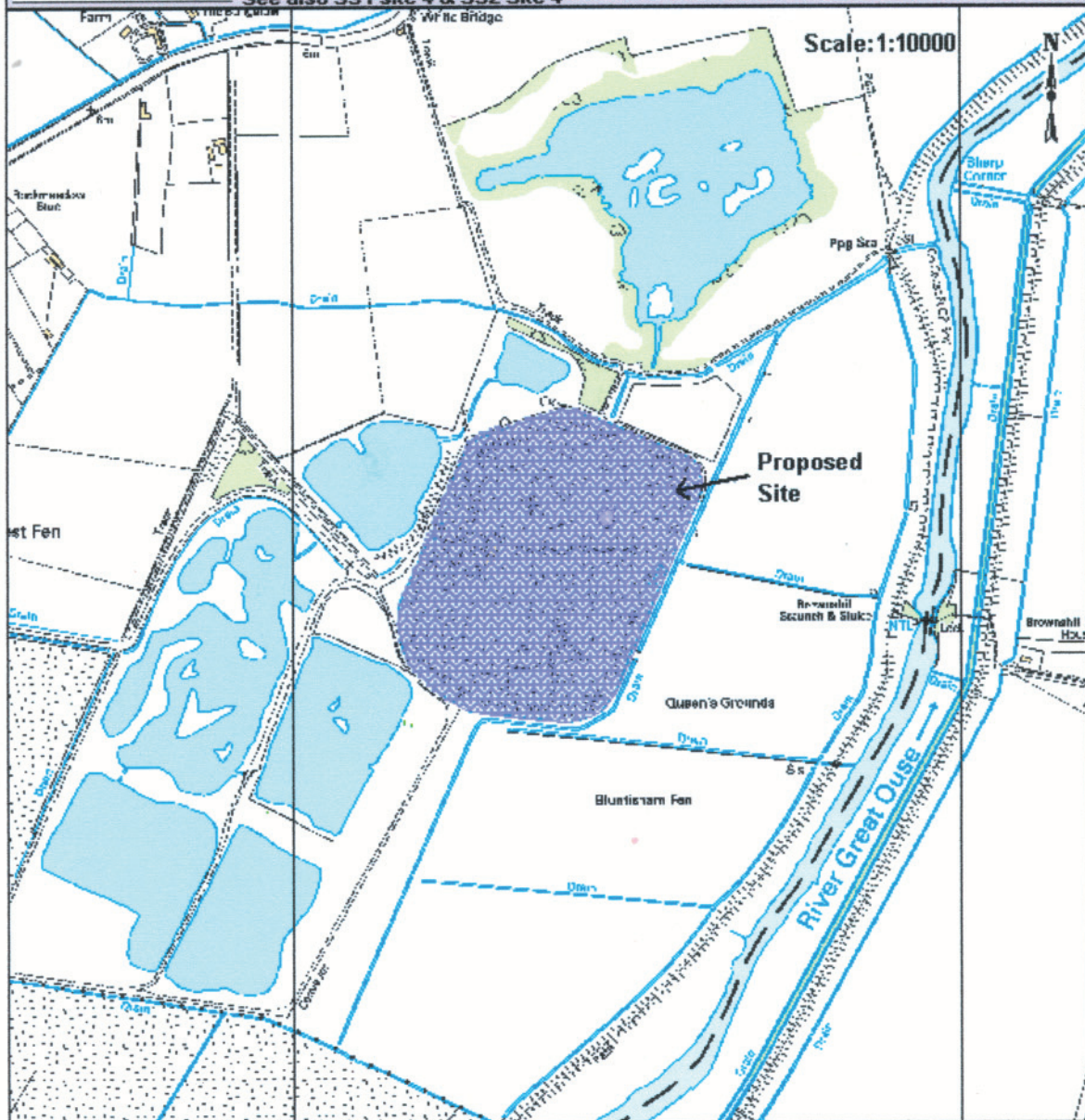

SS4 Site 30: Option 1	Do you support this proposal for a new waste management site, if so why?
SS4 Site 30: Option 2	Do you object to this proposal for a new waste management site, if so why?
SS4 Site 30: Option 3	Do you support this proposal in part, subject to amendments? If so please indicate the amendments requested?

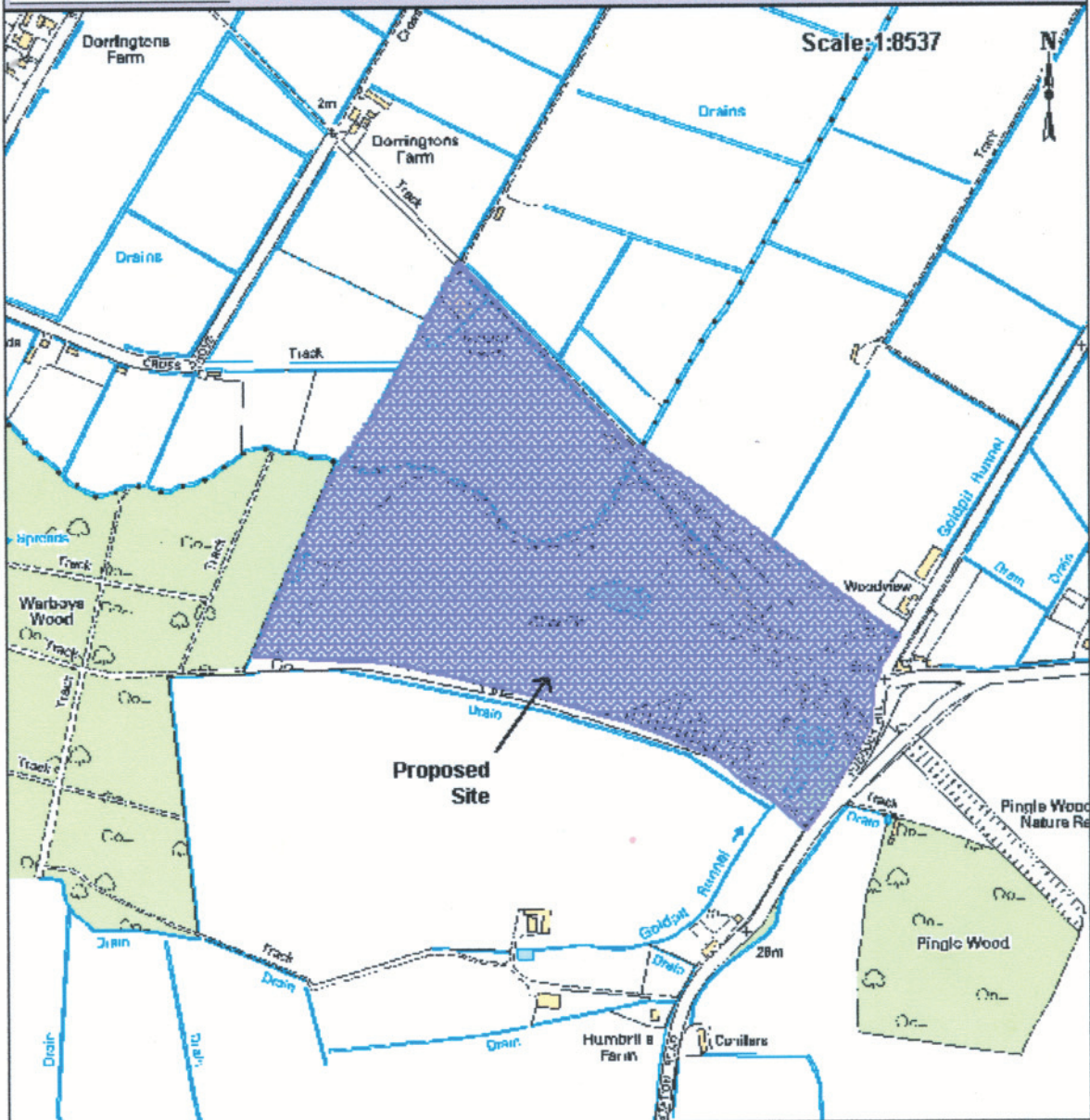

SS4 Site 31: Option 1	Do you support this proposal for a new waste management site, if so why?
SS4 Site 31: Option 2	Do you object to this proposal for a new waste management site, if so why?
SS4 Site 31: Option 3	Do you support this proposal in part, subject to amendments? If so please indicate the amendments requested?

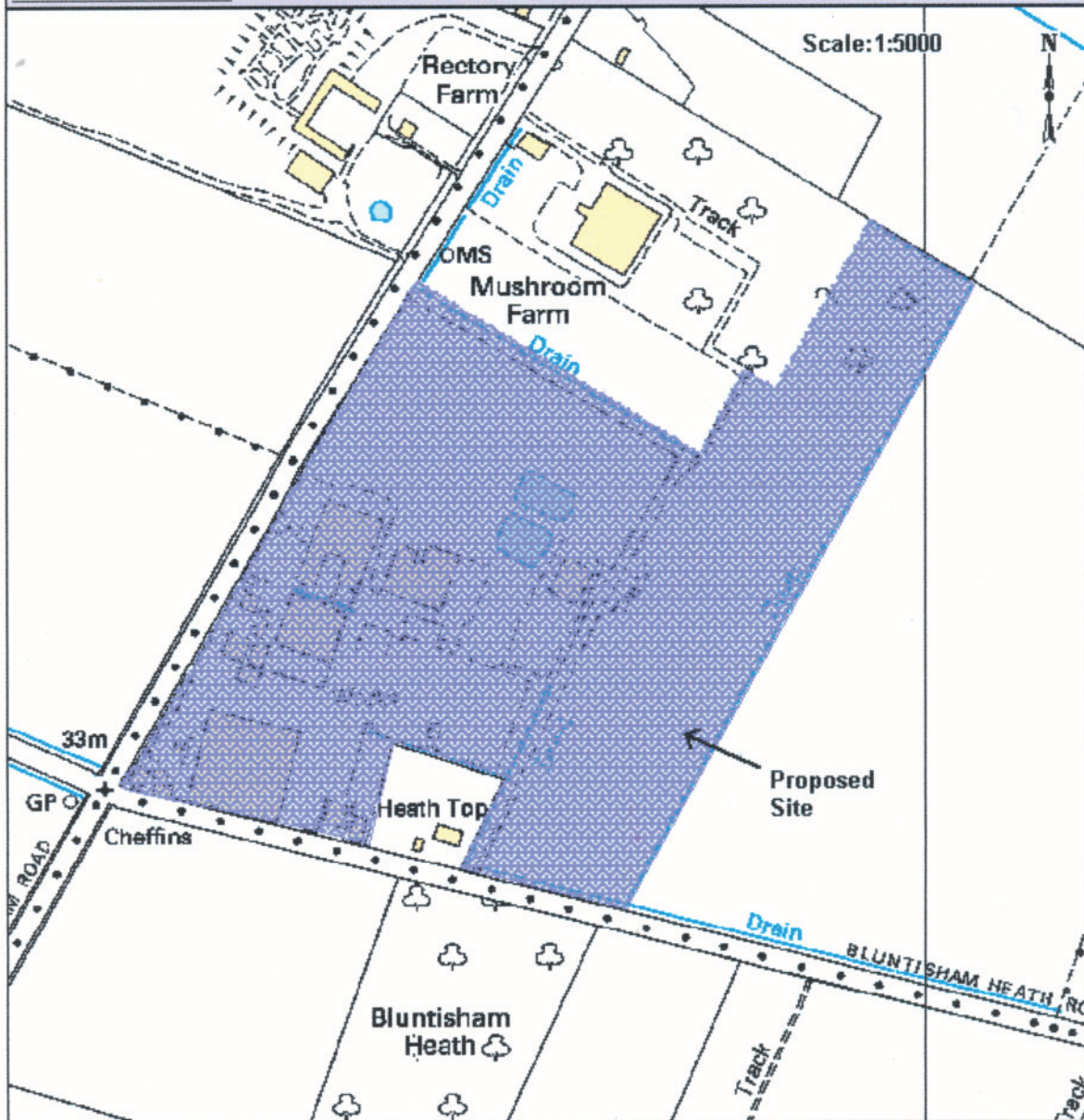

SS4 Site 35: Option 1	Do you support this proposal for a waste management site, if so why?
SS4 Site 35: Option 2	Do you object to this proposal for a waste management site, if so why?
SS4 Site 35: Option 3	Do you support this proposal in part, subject to amendments? If so please indicate the amendments requested?